



INSTRUCTION BULLETIN

No. 340726
Machine: 5680/5700
Published: 09-2004
Rev. 00

NOTE: DO NOT DISCARD the Parts List from the Instruction Bulletin. Place the Parts List in the appropriate place in the machine manual for future reference. Retaining the Parts List will make it easier to reorder individual parts and will save the cost of ordering an entire kit.

NOTE: Numbers in parenthesis () are reference numbers for parts listed in Bill of Materials.

Installation instructions for **kit number 9000548**

SYNOPSIS / PROBLEM:

This kit contains the parts needed to replace the detergent pump on the 5680/57000 model sweepers. Please follow step-by-step instructions.

SPECIAL TOOLS / CONSIDERATIONS: NONE

(Estimated time to complete: 2 hours)

PREPARATION:

1. Drain the solution and recovery tanks.
2. Park the machine on a clean level surface and turn off the machine.

FOR SAFETY: Before leaving or servicing machine, stop on level surface, turn off machine, and remove key.

3. Lower the scrub head.

INSTALLATION:

1. Open the solution tank cover and lock the cover into place.
2. Remove the front cover from the machine.
3. Remove the FaST PAK (K) from the machine. Do not discard the FaST PAK, since it is reinstalled after the new detergent pump is installed.
4. If necessary, loosen the detergent box bracket (L) Refer to Fig. 1.
5. Remove the parts listed in the table below Fig. 1 from the machine. Refer to Fig. 1 for part locations.
6. Apply a light coat of thread sealant to the threads on both brass fittings (4).

7. Thread each brass fitting (4) from the previous step into a brass elbow fitting (3).

NOTE: Refer to Fig 2 for locations and orientation of parts assembled in the remaining steps of this bulletin.

8. Thread the fittings assembled in the previous two steps onto the detergent pump (1).
9. Use two hex screws (7), two washers (9), and two hex nuts (8) to install the detergent pump (1) onto the detergent pump plate (2).
10. Cut 21" from the 36" hose (11). Do not discard the remaining 15" of hose (11).
11. Slide one end of the 21" hose (11) onto the appropriate fitting on the detergent pump (1).
12. Tighten one hose clamp (10) over the end of the 21" hose (11) attached to the fitting on the detergent pump (1) in the previous step.
13. Slide one end of the remaining 15" hose (11) onto the other fitting on the detergent pump (1).
14. Tighten one hose clamp (10) over the end of the 15" hose (11) attached to the fitting on the detergent pump (1) in the previous step.
15. Slide one hose clamp (10) onto the loose end of the 15" hose (11).

16. Use two hex screws (5) and two hex nuts (6) to install the detergent pump plate (2) onto the detergent box bracket (A).
17. Attach the loose end of the 21" hose (11) to the valve coupling (B). If necessary, trim hose to size before attaching it to the valve coupling.
18. Attach the loose end of the 15" hose (11) to the appropriate fitting (D) on the FaST foam filter group. If necessary, trim hose to size before attaching it to the fitting.
19. Tighten the hose clamp (10) over the end of the 15" hose (11) and the fitting (D) on the FaST foam filter group.
20. Attach the detergent pump (1) cable to the same connector the cable from the old pump was connected.
21. If necessary, tighten the detergent box bracket (A) onto the machine.
22. Reinstall the FaST PAK (E) into the detergent box bracket (A).
23. Reinstall the front cover onto the machine.
24. Unlock and close the solution tank cover.
25. Fill the solution tank approximately 1/2 full of cool clean water.
26. Unlock and close the solution tank cover.
27. Turn on the FaST system and propel the machine forward.
28. Scrub a small section of floor to ensure machine is functioning properly. It may take several minutes for the FaST system to reach maximum foaming.

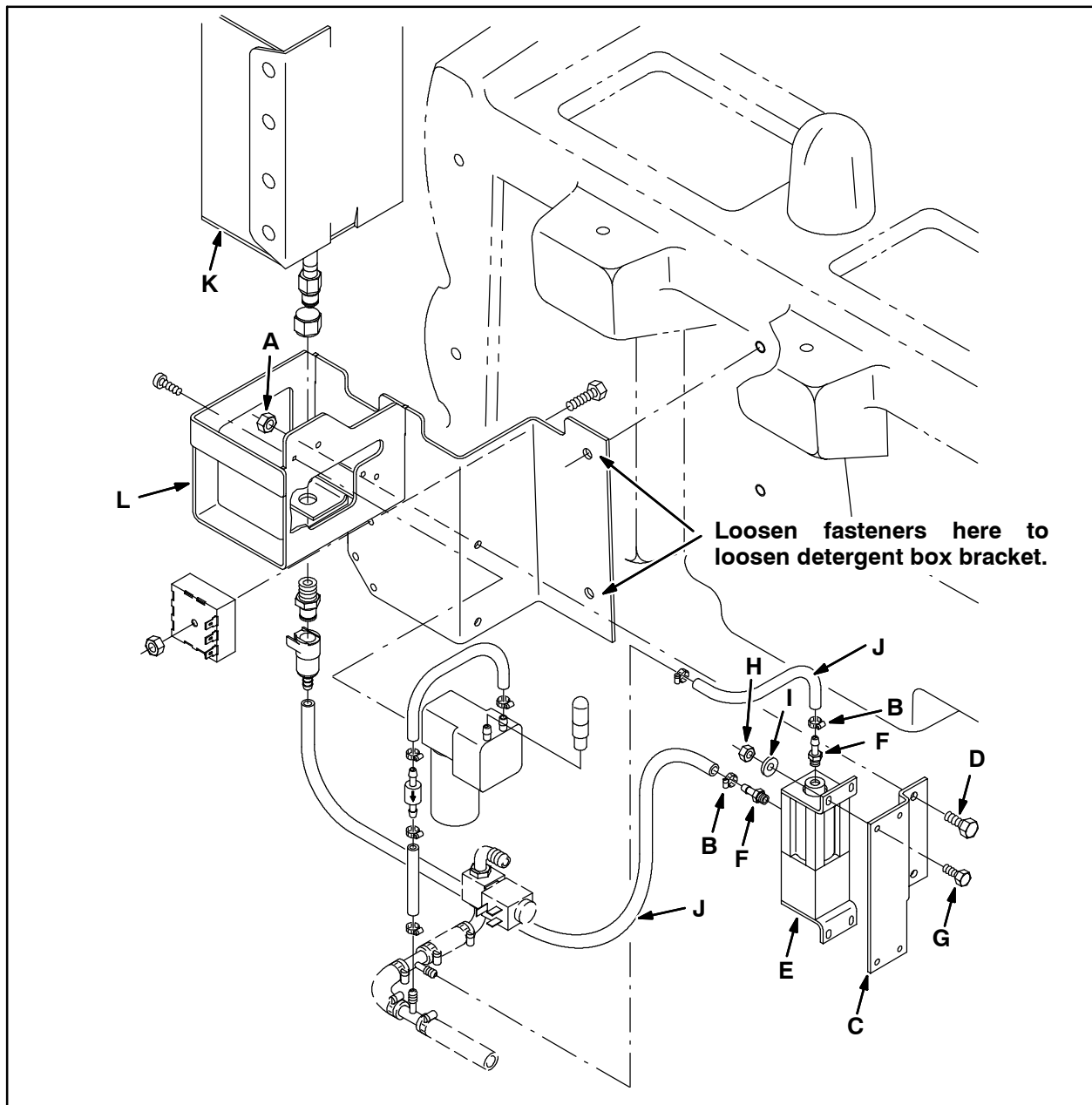

FIG. 1

FaST Air Pump and Detergent Group (000000-022740)-REMOVE ITEMS LISTED BELOW

Ref.	Tennant Part No.	Machine Serial Number	Description	Qty.
A	08708	(000000-022740)	Nut, Hex, Lock, M06 X 1.0, NI	1
B	43844	(000000-022740)	Clamp, Hose, Wormdrive, 0.25-0.62d	2
C	1008354	(000000-022740)	Plate, Mtg, Pump	1
D	08716	(000000-022740)	Screw, Hex, M06 X 1.0 X 20, Ss	2
E	9000548	(000000-022740)	Pump Kit, Detgt, Replmt, [5680/5700]	1
F	1005739	(000000-022740)	Fitting, Plstc, Str, Bm03, 1/4-28, Kynar	2
G	09206	(000000-022740)	Screw, Hex, M04 X 0.7 X 12, 8.8	4
H	42368	(000000-022740)	Nut, Hex, Std, M04 X 0.7	4
I	19065	(000000-022740)	Washer, Flat, #08	4
J	1006415	(000000-022740)	Hose, Afmkt Replmt, Clr, 0.25ID 3FT	1

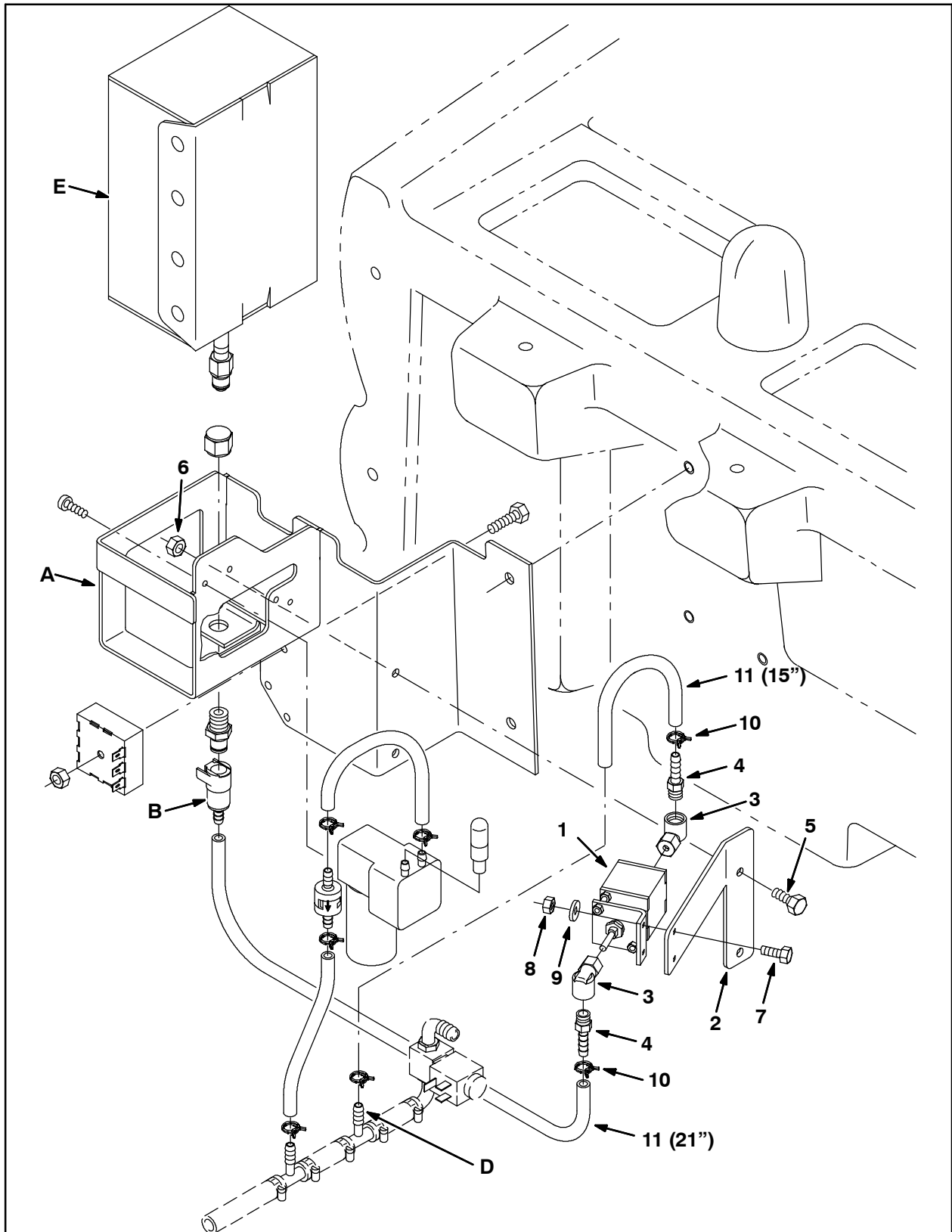

FIG. 2

Bill of Materials for PUMP KIT, DETGT, REPLMT, [5680/5700]

	Ref.	Tennant Part No.	Description	Qty.
▽		9000548	Pump Kit, Detgt, Replmt, [5680/5700]	1
▲	1	1014553	Pump, Detgt, [560S]	1
▲	2	1015042	Plate, Mtg, Detgt Pump	1
▲	3	1014082	Fitting, Brs, E90, CF03/PF02	2
▲	4	150525	Fitting, Brs, Str, PM02/BM04	2
▲	5	08716	Screw, Hex, M6 X 1.0 X 20, SS	2
▲	6	08712	Nut, Hex, Lock, M6 X 1.0, SS, NL	2
▲	7	09206	Screw, Hex, M4 X 0.7 X 12, 8.8	2
▲	8	42368	Nut, Hex, Std, M4 X 0.7, 8	2
▲	9	19065	Washer, Flat, #08	2
▲	10	613735	Clamp, Hose, Wire, .40-.42	3
▲	11	1006415	Hose, Afmkt, Pvc, Clr 0.25ID 3FT	1

TENNANT COMPANY
P. O. Box 1452
Minneapolis, MN 55440-1452